

User instructions

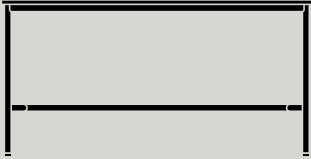

Drip HW61-HW64

Hee Welling

2021

Congratulations on your new Drip table, designed in 2021 by Hee Welling. We hope you will enjoy using this product. Please follow these instructions to ensure correct assembly. If you have any questions or comments, please do not hesitate to contact us by mail at:

info@andtradition.com

Drip HW61-HW64

Hee Welling

2021

Please read these instructions carefully and keep them for future reference to ensure the product is used correctly. For your own safety, please read each step of this instruction manual first. &Tradition is not responsible for any faults or damages caused by not following these instructions correctly. Do not modify this product in any way.

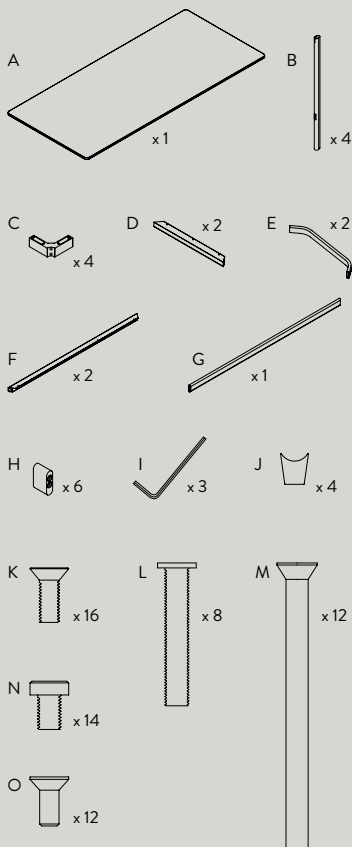

Contents

- A Tabletop
- B Legs x 4
- C Corners x 4
- D Long frames x 2
- E End-crossbars x 2
- F Short frames x 2
- G Middle crossbar
- H Adaptor x 6
- I Allen key x 3
- J Cover components x 4
- K Flat head hex screws x 16
- L Long button screws x 8
- M Long hex screws x 12
- N Short button screws x 14
- O Short hex screws x 12

Safety precautions

- Dispose of plastic bag from packaging and do keep out of reach of children.
- The table is only intended for indoor use.
- Handle tabletop with care in order not to scratch surfaces.
- Two or more adults are required when lifting the table.

Cleaning instructions

Laminate can be cleaned with a soft cloth wrung in a mild solution of lukewarm water and a universal cleaning detergent. Always wipe with a dry soft cloth after cleaning. For difficult stains such as coffee or tea use a nylon bristle brush with mild household cleaner or detergent, rinsing with clean water and repeating as necessary. Rinse thoroughly with water.

Aluminium (powder coated or polished) can be cleaned using a soft cloth wrung in lukewarm water. Always dry immediately with a soft cloth. Avoid use of abrasive cleaning products such as steel wool as this will damage the surface.

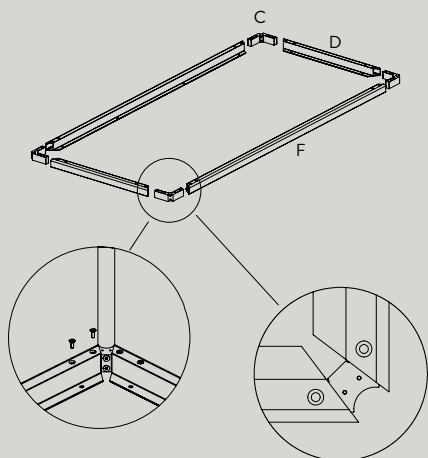

NB! Make sure the holes on the corner (C) are facing up.

Step 1

Insert the corners (C) into the frames (D & F) as shown and attach them with screw (K). The two small holes on the corners (C) must be facing upwards - see illustration.

Important: Only install the screws slightly and then finally tighten all of them.

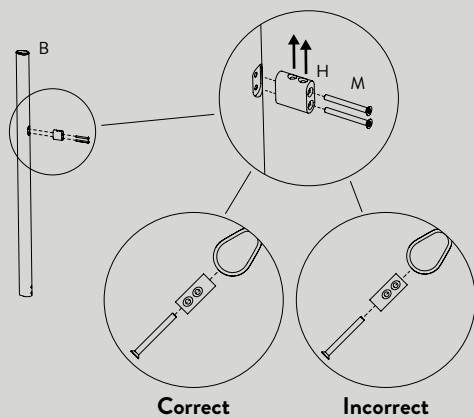

Step 2

Install one adaptor (H) in the lower middle part of each leg (B) using two long hex screws (M). Make sure to place adaptor in the correct direction - see illustrations.

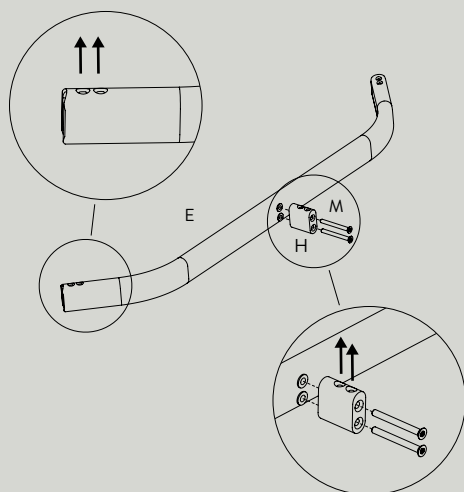

Step 3

Connect one adaptor (H) in the middle of each end-crossbar (E) using two long hex screws (M). Please make sure that the adaptor (H) and the crossbars are facing in the correct direction - see illustration.

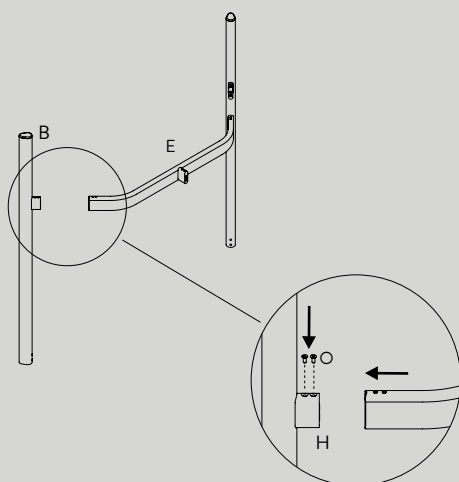

Step 4

Connect the crossbar (E) to two legs using the short hex screws (O).

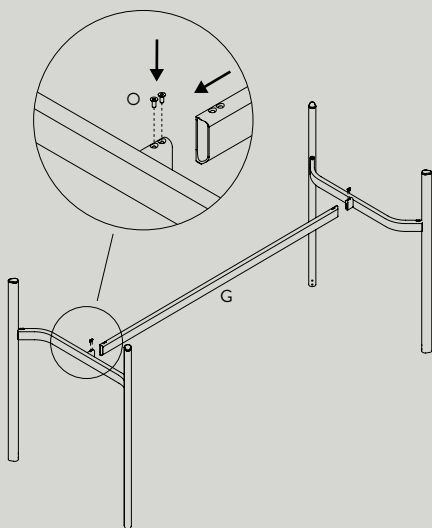

Step 5

Attach the middle crossbar to (G) and make sure that the holes are in the correct direction - see illustration.

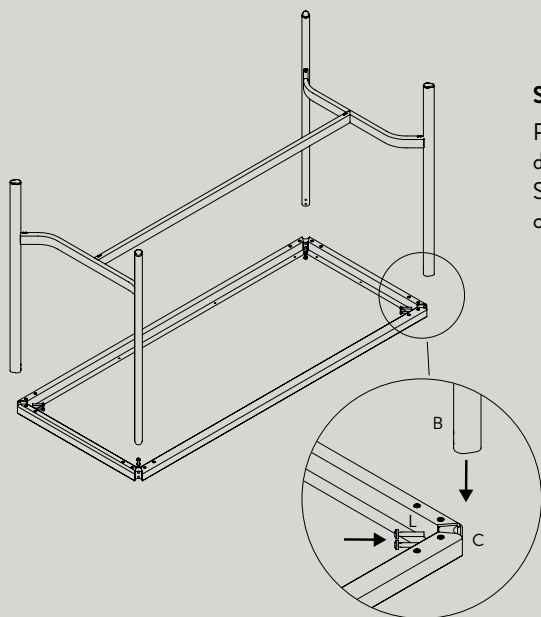

Step 6

Place the leg-section on the frame upside down and align all four legs in each corner (C). Screw two long button screws (L) in each corner to connect them.

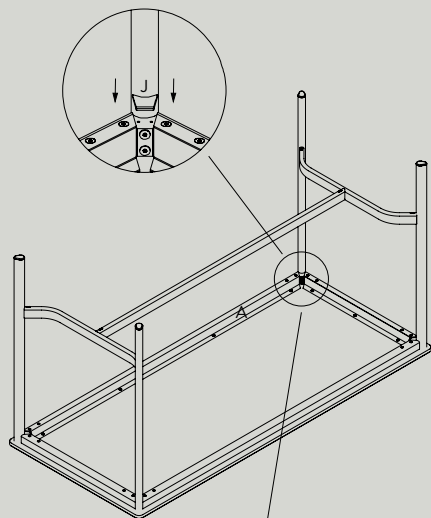

Step 7

Place the cover components (J) on each of the 4 corners

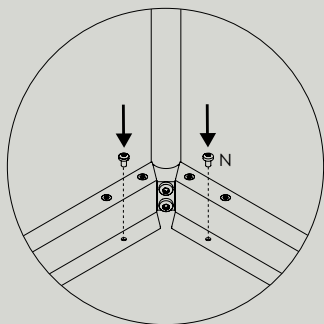

Step 8

Place the tabletop (A) upside down on a soft, flat surface and place the frame on top, upside down.

Important: Install only the screws (N) slightly and then finally tighten all of them to secure correct fit.

Finally, flip the table and enjoy your product.

&Tradition®